



# EFFICIENT AMENITIES

Recreational Consultants  
**INSPIRE ASSEMBLE UNITE**



**4,000+**  
Recreation **Products**  
Available for You  
to **Choose From**



VOL. 2 BUYER'S GUIDE

Playground Equipment • Dog Parks • Shade & Shelter • Athletic Equipment • Water Slides



View Products, Request Quote  
[e-merities.com](http://e-merities.com)



Send Us a Message  
[sales@e-merities.com](mailto:sales@e-merities.com)



Call Us  
**855.884.8387**  
**678.390.1590**

Take a peek at what is

# All New, For You!

As your exclusive provider of all recreational needs, we strive to exceed the expectations of present day standards. We are continually developing our designs and embracing complex solutions; assuring you work with the best that this industry has to offer. Browse our innovative designs and imagine where we can take your park or recreation areas.

## Check Out our Latest Products

**Theme & Active Outdoor Playground Structures**  
p. 14-15



**Interactive Musical Play Equipment**  
p. 20-21



**Dog Park Amenities, Aluminum Bleachers**  
p. 34, p. 45



**Portable Retractable Umbrella**  
p. 37



**07** Commercial, Theme, and Custom Playgrounds

**17** Freestanding Equipment

**26** Infant & Preschool

**27** Fitness Equipment

**28** Indoor and Water Slides

**32** Shelter Structures

**34** Dog Park Equipment

**36** Shade Structures

**39** Site Amenities

**44** Athletic Equipment

**45** Bleachers & Bleacher Shade

**46** Safety Surfacing



Shelter Structures



Interactive Music Equipment



Shading



Commercial Playgrounds

# Recreation Inspiration



Dog Park Equipment

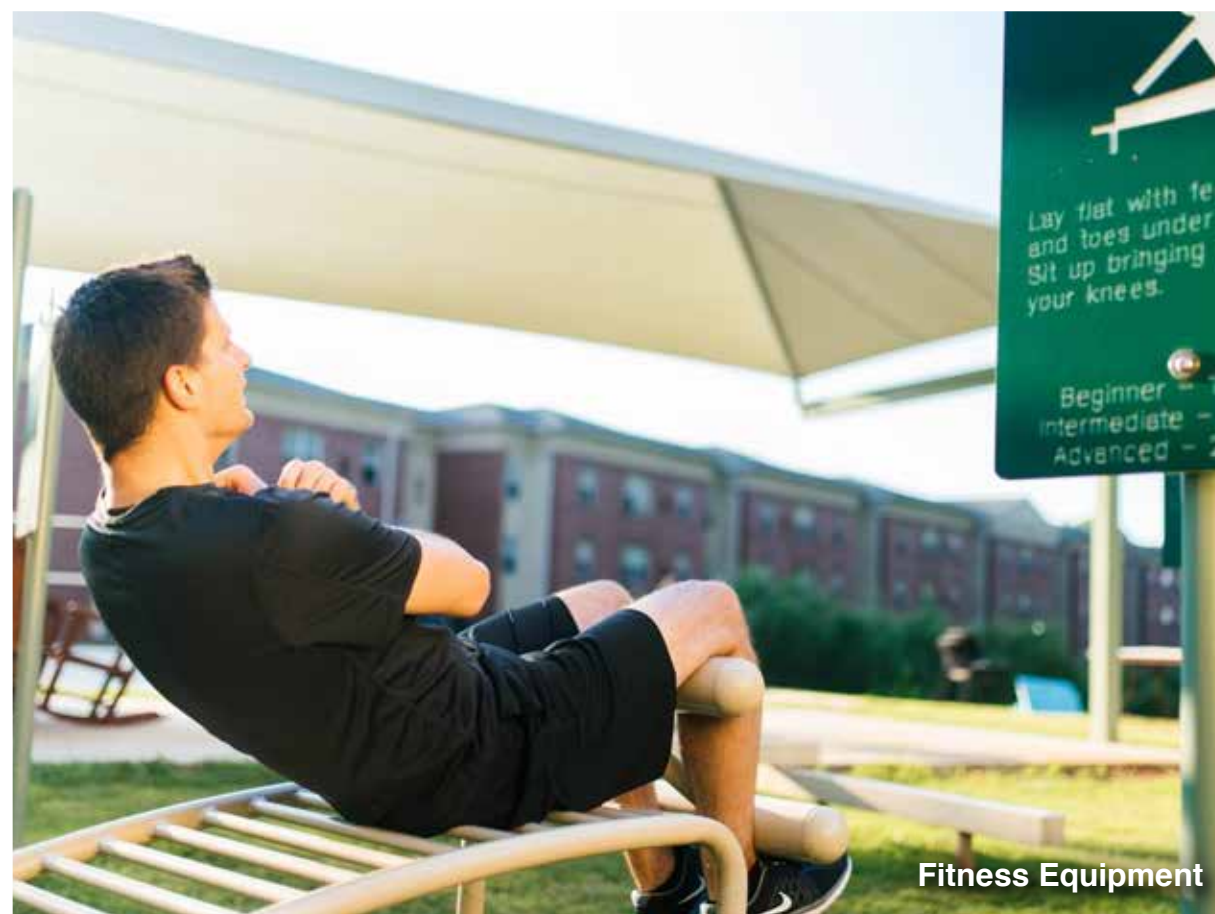

Fitness Equipment

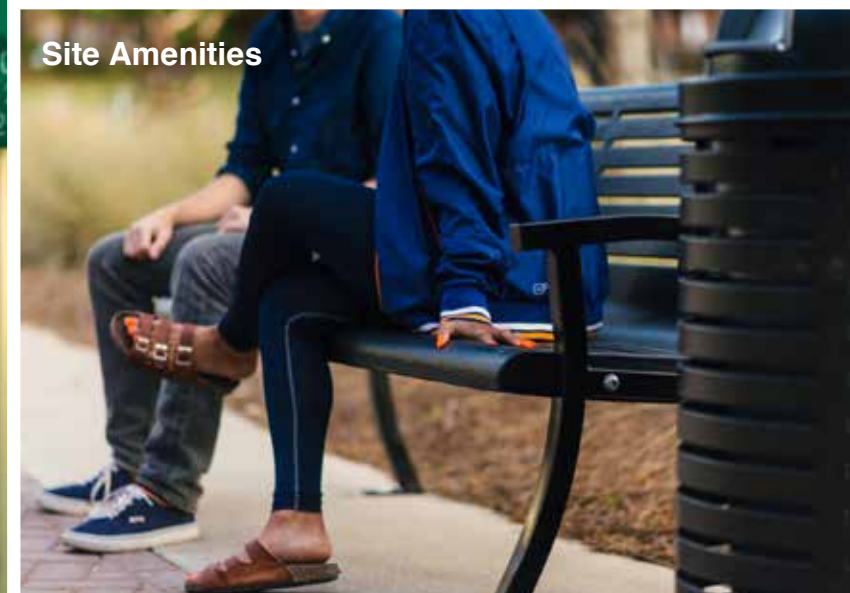

Site Amenities

Why Choose Efficient Amenities?

# Complete Turn-Key Project Providers

The drive of our company has been unprecedented customer service. We guarantee that you will receive the highest quality care from your consultation through the end to installation and maintenance.



### Top Design Support

Whether you're a property manager, child care director, pool operator, or any in between, we can provide the best to match your recreational needs.

### Full-Time Installation Teams

Our team of trained and certified installers is available full time to bring your vision to reality; regardless of your location.

### Experienced Consultants

Our elite team of consultants have over 36 years' experience in the recreational equipment field. Every quote for equipment includes a free design package and estimate.

### Maintenance Program

The majority of our installations qualify for a maintenance program; which keeps your investment in high quality conditions for years to come.



### Turn-Key Supplier

We offer over 4,000 amenities to enhance your recreational interests. From water slides and canopies, to safety surfacing and dog parks, we can provide and customize the ideal environment for you.

### Production Partnerships

We select our manufacturing partners based on their high quality, innovation, and customer support. Conveniently, most of our manufacturers are located within one mile of our warehouse and office.



# Commercial Playgrounds

**Make your playground extraordinary. Our design consultants can help!**

Efficient Amenities takes pride in not only our strong team of "playground people", but in the materials and standards that we use as the base for our recreational structures. Our products abide by IPEMA safety standards and are created with superb engineering components. If you are looking for a high quality recreational piece with high "play value", our company is the ideal choice from creation to installation. In addition to the highest safety standards, our equipment comes in

a collection of designs and colors, making your site fully customizable.

**Commercial playground equipment:**

- Structures, swings, spinners, rockers and more
- Toddler structures and mazes that promote social interaction and challenge
- Decks, climbers, bridges, crawl tubes, and overhead climbers



**EA-4900** \$17,812.56

Size:	28' x 21'	Child Capacity:	34
Use zone:	40' x 33'	Age Range:	2-12
Surface Area:	838		



**EA-5099** \$13,800.87

Size:	24' x 18'	Child Capacity:	26
Use zone:	36' x 30'	Age Range:	5-12
Surface Area:	824		



**EA-4996** \$15,320.26

Size:	26' x 21'	Child Capacity:	22
Use zone:	38' x 33'	Age Range:	2-12
Surface Area:	916		



**EA-4997** \$14,692.40

Size:	19' x 24'	Child Capacity:	24
Use zone:	31' x 36'	Age Range:	5-12
Surface Area:	800		



**EA-4914** \$15,792.03

Size:	28' x 24'	Child Capacity:	32
Use zone:	40' x 36'	Age Range:	5-12
Surface Area:	1060		



**EA-4991** \$13,020.89

Size:	16' x 18'	Child Capacity:	22
Use zone:	28' x 30'	Age Range:	2-5
Surface Area:	636		



**EA-5008** \$18,581.00

Size:	28' x 15'	Child Capacity:	32
Use zone:	40' x 27'	Age Range:	2-12
Surface Area:	740		



**EA-5009** \$16,819.43

Size:	22' x 20'	Child Capacity:	29
Use zone:	34' x 32'	Age Range:	2-5
Surface Area:	774		



**EA-4992** \$14,928.74

Size:	26' x 10'	Child Capacity:	26
Use zone:	38' x 22'	Age Range:	2-12
Surface Area:	648		



**EA-4994** \$9,232.71

Size:	17' x 11'	Child Capacity:	20
Use zone:	29' x 23'	Age Range:	2-12
Surface Area:	524		



**EA-5010** \$11,889.59

Size:	21' x 12'	Child Capacity:	22
Use zone:	33' x 24'	Age Range:	5-12
Surface Area:	597		



**EA-5011** \$8,763.53

Size:	17' x 14'	Child Capacity:	20
Use zone:	29' x 26'	Age Range:	5-12
Surface Area:	540		



**EA-5012** \$30,551.53

Size:	31' x 28'	Child Capacity:	50
Use zone:	43' x 40'	Age Range:	5-12
Surface Area:	1245		



**EA-5013** \$13,950.66

Size:	15' x 15'	Child Capacity:	24
Use zone:	27' x 27'	Age Range:	2-12
Surface Area:	609		



**EA-5023** \$28,821.19

Size:	38' x 22'	Child Capacity:	46
Use zone:	50' x 34'	Age Range:	5-12
Surface Area:	1154		



**EA-5024** \$11,526.30

Size:	11' x 9'	Child Capacity:	12
Use zone:	11' x 9'	Age Range:	0-2
Surface Area:	n/a		



**EA-5014** \$11,495.44

Size:	18' x 16'	Child Capacity:	24
Use zone:	30' x 28'	Age Range:	2-5
Surface Area:	616		



**EA-5015** \$15,786.91

Size:	21' x 20'	Child Capacity:	28
Use zone:	33' x 32'	Age Range:	2-5
Surface Area:	771		



**EA-5025** \$18,202.23

Size:	31' x 11'	Child Capacity:	15
Use zone:	43' x 23'	Age Range:	5-12
Surface Area:	1364		



**EA-5026** \$51,555.03

Size:	46' x 24'	Child Capacity:	89
Use zone:	58' x 36'	Age Range:	5-12
Surface Area:	1406		



**EA-5020** \$21,651.29

Size:	32' x 16'	Child Capacity:	26
Use zone:	44' x 28'	Age Range:	2-12
Surface Area:	865		



**EA-5021** \$23,925.71

Size:	28' x 20'	Child Capacity:	28
Use zone:	40' x 32'	Age Range:	2-12
Surface Area:	871		



**EA-5027** \$13,160.00

Size:	26' x 16'	Child Capacity:	26
Use zone:	38' x 18'	Age Range:	2-12
Surface Area:	549		



**EA-5028** \$23,309.36

Size:	23' x 22'	Child Capacity:	45
Use zone:	35' x 34'	Age Range:	2-12
Surface Area:	884		



**EA-5029** \$24,029.70

Size:	26' x 18'	Child Capacity:	32
Use zone:	38' x 30'	Age Range:	5-12
Surface Area:	854		



**EA-5030** \$17,346.41

Size:	26' x 23'	Child Capacity:	29
Use zone:	38' x 35'	Age Range:	5-12
Surface Area:	842		



**CW-0001** \$13,225.80

Size:	25' x 14'	Child Capacity:	26
Use zone:	37' x 26'	Age Range:	5-12
Surface Area:	698		



**CW-0002** \$16,321.20

Size:	29' x 23'	Child Capacity:	26
Use zone:	41' x 35'	Age Range:	5-12
Surface Area:	1068		



**EA-5031** \$15,463.71

Size:	26' x 12'	Child Capacity:	27
Use zone:	38' x 24'	Age Range:	2-5
Surface Area:	727		



**EA-5033** \$23,133.63

Size:	28' x 19'	Child Capacity:	42
Use zone:	40' x 31'	Age Range:	2-5
Surface Area:	844		



**CW-0003** \$20,466.60

Size:	31' x 16'	Child Capacity:	26
Use zone:	43' x 28'	Age Range:	2-12
Surface Area:	782		



**CW-0004** \$12,781.65

Size:	26' x 10'	Child Capacity:	26
Use zone:	38' x 22'	Age Range:	2-12
Surface Area:	644		



**EA-5034** \$12,757.76

Size:	21' x 8'	Child Capacity:	22
Use zone:	33' x 20'	Age Range:	2-12
Surface Area:	542		



**EA-5035** \$27,557.71

Size:	24' x 24'	Child Capacity:	42
Use zone:	36' x 36'	Age Range:	5-12
Surface Area:	1023		



**CW-0005** \$18,905.25

Size:	26' x 21'	Child Capacity:	38
Use zone:	38' x 33'	Age Range:	2-12
Surface Area:	940		



**CW-0006** \$9,829.05

Size:	18' x 16'	Child Capacity:	18
Use zone:	30' x 28'	Age Range:	5-12
Surface Area:	557		

**New!**



**PKP010** \$13,096  
 Size: Child Capacity: 36-42  
 Use zone: 26' x 35' Age Range: 2-12



**PKP105** \$7,530  
 Size: Child Capacity: 16-19  
 Use zone: 24' x 25' Age Range: 2-12



**PGP008** \$26,510  
 Size: Child Capacity: 37-43  
 Use zone: 51' x 54' Age Range: 5-12

**New!**  
 Ask us about the matching caboose!



**R3FX-30002** \$14,594  
 Size: Child Capacity: 30-35  
 Use zone: 34' x 21' Age Range: 2-5



**PKP136** \$9,828  
 Size: Child Capacity: 27-31  
 Use zone: 27' x 29' Age Range: 5-12



**PKP152** \$10,206  
 Size: Child Capacity: 23-27  
 Use zone: 23' x 32' Age Range: 2-12



**PTP001** \$16,190  
 Size: Child Capacity: 27-31  
 Use zone: 31' x 31' Age Range: 2-12



**PTP014** \$45,010  
 Size: Child Capacity: 60-69  
 Use zone: 47' x 50' Age Range: 5-12



**PKP140** \$13,824  
 Size: Child Capacity: 34-39  
 Use zone: 30' x 33' Age Range: 2-12



**PGP011** \$9,270  
 Size: Child Capacity: 17-20  
 Use zone: 31' x 36' Age Range: 5-12



**PNL008** \$23,348  
 Size: Child Capacity: 23-27  
 Use zone: 26' x 35' Age Range: 2-12



**PPS003** \$33,234  
 Size: Child Capacity: 45-52  
 Use zone: 37' x 47' Age Range: 2-12



Great options for phasing!



**CW-0020** \$31,454.85  
 Size: 34' x 23' Child Capacity: 40  
 Use zone: 46' x 35' Age Range: 5-12  
 Surface Area: 1018



**CW-0021** \$61,458.60  
 Size: 40' x 35' Child Capacity: 82  
 Use zone: 52' x 47' Age Range: 2-12  
 Surface Area: 1628

# Custom Playground Designs

We can design any playground environment you envision!

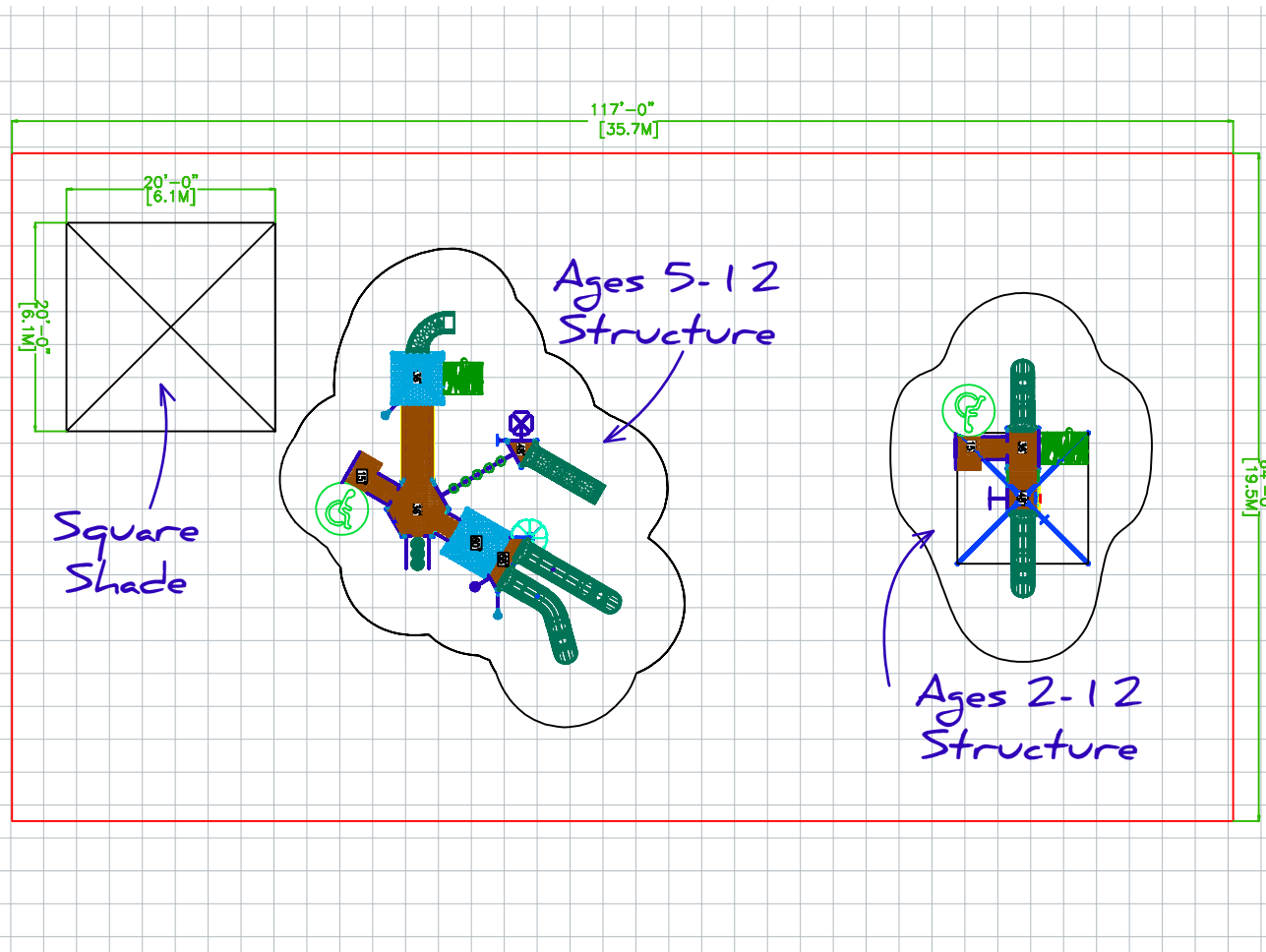

## Freestanding Slides



**5' Wave**  
 AFR0131XX \$3,465.00



**4' Triple Rail**  
 AFR0139XX \$4,834.00



**4' Straight**  
 SLIDE-P \$2,345.00



**6' Open Spiral**  
 AFR0163XX \$5,557.00



**4' 90 Degree Curve**  
 AFR0137XX \$3,610.00



**8' Triple Chute**  
 AFR0187XX Call for pricing

## Climbers



**Bubble Wall Climber**  
 TFR09121XX \$2,873.85



**C Bridge 2**  
 87000038XX \$3,120.00



**PlayShell Amphitheater**  
 BT-254 \$3,899.00



**Camel Back Kids**  
 90007112 \$1,807.00



**Super Dome**  
 501-121 \$2,160.00



**Craggy Pinnacle Climber**  
 PCR001 \$4,524.00

**Overhead Climbers**



**Over Under Climber**  
AFR0165XX \$2,839.00



**10' Track Ride**  
AFR0118XX \$2,673.00



**Junior Horizontal Ladder**  
90009000XX \$912.00

**Webs & Boulders**

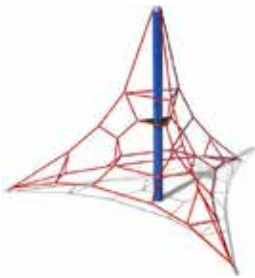

**SM Tetranet**  
DX-SM01 \$6,290.00



**Mini Top**  
DX-1400 \$5,570.00

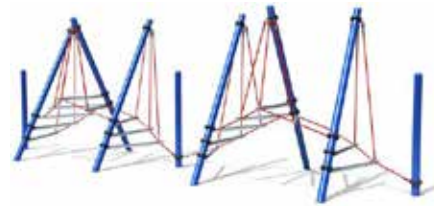

**Balancing Course**  
IM-1005 \$20,890.00



**Stepping Turtles – Set of 5**  
5ST \$1,195.00



**Granite Boulder – Medium**  
GRN-MD \$8,595.00



**Sandstone Boulder – Large**  
SND-LG \$14,995.00

**Loose Activities**



**Stack Block Mega Set**  
28200 \$2,333.10



**Snug Play Mini Kit**  
SNUG-MNKIT \$3,495.00



**Snug Starter Kit**  
SNUG STARTER KIT \$10,995.00

**Tunnels & Caves**



**Chatter Bug**  
BT-260 \$739.00



**Funny Bones**  
EC-244 \$779.00



**Climb and Discover Cave**  
MEC-027 \$3,099



**Freestanding Crawl Tunnel Kit**  
02-07-0057-RED \$699.00



**4' Log Tunnel**  
4LT \$3,395.00



**Crawl Through Tunnel**  
MEC-011 \$1,239.00

**Dramatic Play**



**Tot Town™ Mushroom Kottage**  
301-145A \$2,279.00



**Trike Track Feature Items**  
PS3-28227 \$3,660.00

**Ground Level Arch Bridge**  
TFR13389XX \$3,341.00



**Cat's Den**  
66503 \$3,295.00

Includes gas station, store front, talk tubes, three traffic signs. Rubber track and arch bridge not included.

**Music**



**Freestanding Glockenspiel with Base**  
77131 \$803.00



**Music Wall**  
71601 \$3,775.00



**Deluxe Package / Ensemble 4 Instruments**  
FREENOTES 17 \$14,400.00

Turn for NEW music options!

**New!**



**Audionetic** \$2,640.63

**Great games that stimulate exercise and collaboration!** By pumping the foot pedal children generate energy. Powered up? Press the push button and a selection of games will follow. stories, games, riddles, jokes, biblical stories or fables...OR, you can add hours of your own content – up to 12GB! Ask us how!



**Music/StoryBall** \$2,727.68

The MusicBall will make you want to dance and sing, so it's a cheerful way for children to develop! **After you turn the crank, the Music Ball will play well-known Children's songs or up to 12GB of your own content** so everyone can sing along.



**KineticWheel** \$2,756.70

Spin the wheel and energize the KineticWheel. You will (randomly) hear an audio clip full of experience. All three of the steering wheel variants come with a USB stick with their own sound! **Always wanted to be a pilot? Sail the seas like a pirate? Experience the feeling of a driver in the cockpit? It's all possible!**



**New!**

**DJ Post** \$3,191.96

Turn the disc, keep turning! This generates energy. **Put your phone on loudspeaker and put it under the hut. The DJ Post amplifies the sound from your Smartphone!** No Bluetooth, no cables! The built-in tech picks up the sound of your Smartphone automatically.



**Game Netic** \$3,191.96

**Use your foot to pump the pedal, generate energy for the GAMES to begin!** This game console is provided with 4 interactive games. Test your speed, memory, counting skills and reaction ability.



**Jump Stone** \$2,756.70

By jumping, you will generate energy and a randomly selected song will play. **You have to keep jumping in order to let the audio continue.** Very intense, but luckily you have time to swap with someone to keep the songs going.



**ConnectIT (Walky Talky Set)** \$4,062.50

**Generate electricity by turning the hand crank. Press the button and start chatting.** Connect-IT is like a walkie-talkie that can broadcast up to 1 mile away. You and your partners just crank the handle and speak into the microphone.



**AudioZone** \$7,544.64

**Turn the crank and energize the AudioZone.** Now you can play the game using the sidekicks. Do you know the right answer? Then sprint to the illuminated sidekick and kick it. Using your hands, feet, with a ball or whatever you come up with.

**Rockers**



**Surf Rider**  
90018002XX \$889.00



**Motorcycle Spring Rider**  
MEC-127 \$909.00



**4-Seat See-Saw**  
TFR04666XX \$2,885.00



**Freddie The Frog**  
90018202 \$567.00



**Two-Seat Retro Rocker Teeter**  
90018204XX \$792.00



**Dolphin Spring Rider**  
MEC-128 \$879.00

**Spinners**



**Spin About**  
TFR08714 \$1,003.00



**Synchro Pod**  
MBT-430 \$389.00



**Whirl and Twirl**  
BT-002 \$617.00



**Merry-Go-Round 8' Diameter**  
301-143 \$2,894.00



**Cyclone Spinner**  
BT-441 \$2,417.00



**Mini Cyclone**  
BT-440 \$1,327.00



**5" Single Post Swing Frame**  
EFR0051XX \$1,035.00

Unique low-maintenance space-saving frame for smaller areas! Manufactured with heavy-duty cast aluminum junctions and powder-coated frames and top bar. Frame only; seats sold separately.



**Arch Swing Frames**

Same steel used in our EA and CW structures. Frame only; seats sold separately.

3.5" 2 Bay: 90015202XX \$2,138.00  
5" 3 Bay: 90015503XX \$4,627.00  
5" 1 Bay Tire Swing Frame: 90015991XX \$2,145.00



**Bi-Pod 2 Bay Swing Frame**  
90015402XX \$1,117.00

Take the advantage of the tri-pod frame of going 10' high for added swing play. 280 lbs., frame only; seats sold separately.



**Tri-Pod 4 Bay Swing Frame**  
90015304XX \$2,304.00

This swing frame uses powder-coated aluminum castings for its junctions and galvanized tube (2 3/8"). 530 lbs., 8' high, frame only; seats sold separately.

**Sand & Water**



**5' x 10' Sandbox with Cover, 4-Corner Seats, Ground Barrier, 24 Stakes**  
CSG-60120 \$589.00



**10' Square Sandbox**  
EC-121 \$2,659



**Water Table**  
EC-610 \$349.00

**Independent**



**Triple Toss with Post**  
TRT-10 \$635.00



**Tether Ball with Post**  
60019301 \$271.00



**3.5" Talk Tube**  
TFR04700XX \$396.00

**Balance**



**Tree Stumps – Set of 5**  
MEC-239 \$489.00



**Zig Zag Balance Beam**  
90021016XX \$358.00



**15.5" Rubber Mushroom**  
MS-03 \$406.00

**Dynamic Motion**



**Moving Tunnels**  
EC-625 \$1,129.00



**Rock 'N Cross**  
ME05 \$6,299.00



**EpiCenter**  
ME08 \$7,479.00

**Merry-Go-Round**



**10' Merry-Go-Round**  
301-146 \$6,447.00



**Mini Merry-Go-Cycle**  
11589 \$1,445.00



**Tea Cup Merry-Go-Round**  
902-788 \$2,591

**ADA**



**Elevated Sand Table**  
EC-124 \$1,189.00



**Wheelchair Swing Frame – Adult Platform**  
382-404H \$1,926.00



**Made for Me Adaptive Swing Seat**  
S86010 \$449.00

**Arts**



**Paint Station**  
90000005XX \$923.00



**Café Table – Table Only**  
TFR15931XX \$164.00



**Wood Freestanding Gallery Panel**  
EC-005 \$679.00

**Sensory Motor**



**Bird's Nest Multi-person Swing**  
581-370 \$3,999.00



**Embankment Slides**  
MEC-109 \$2,219.00



**Junior Synchro Spinner**  
MEC-130 \$849.00

6-23 Months



**Toddler Wood Pull-Up Bar**  
EC-017 \$459.00



**Rock & Glide**  
MEC-243 \$899.00



**Kinder Crossing**  
MEC-009 \$2,499.00



**Super Sprout**  
DC-SS / 02-08-0163 \$1,999.00



**Cruise-A-Long**  
UP 136 \$1,889.00



**Seedling with Roof**  
DC-SEEDR / 02-08-0166 \$3,299.00

Active Adult Fitness



**Assisted Double Cycle**  
UP360 \$6,629.00



**Assisted Step Trainer**  
UP353 \$3,549.00



**Energy & Strength Wheels**  
UP358 \$2,994.00

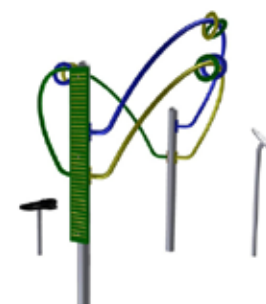

**Skill Trainer**  
UP354 \$2,192.00



**Assisted Functional Trainer**  
UP351 \$1,937.00



**Assisted Balance Walk**  
UP352 \$1,365.00

Preschool



**Merry-Go-Cycle**  
11572 \$1,675.00



**Springed School Bus**  
87308 \$6,980



**Baby Stegosaurus**  
85024 \$3,875

Outdoor Fitness



**10 Station Course**  
60019400XX \$9,466.00



**Stretching Post**  
60019404XX \$630.00



**Beam Run**  
60019405XX \$571.00

Kids Furnishings



**Buddy Bench**  
B6WBPERFP-POLY-STD BLOCK \$483.00



**Friendship Table**  
MEC-024 \$579.00



**3' Preschool Bench**  
940PPS-V3 \$374.00



**Pull/Chin Up Bars**  
60019403XX \$792



**Sit-Up Bench**  
AFT13972XX \$1,279.00  
Inground Kit Required: FIT14050XX



**Pull-Up/Dip Station**  
AFT14031 \$1,607  
Inground Kit Required: FIT14050XX



# Indoor and Water Slides

## Ideal for all locations!

With Efficient Amenities you can create your own world of fun and recreation whether it be indoor or outdoor. The possibilities are endless with our indoor soft contained play systems. These systems offer a unique combination of fun, exploration, and exercise in an ideal way for churches, restaurants, or any environment

where outdoor play is not accessible. Do you dream of transforming your pool into a thrill ride? Do you want to plunge your mainstream pool experience into endless adventure? Set your pool apart from all the others with the endless fun found in our commercial quality water slides!



A



B



C



D



E



F



G



H



I



J

- A. 6177-0** \$94,704.00  
Size: 18'6" x 32'3" x 18'6"  
Capacity: 52  
**Featured Components:**  
4-Level Spiral Slide, Tri-Plane, Turbo Copter, Snake Crawl
- B. 6198-0** \$71,884.00  
Size: 18'2" x 18'4" x 16'10"  
Capacity: 40  
**Featured Components:**  
Rocket Climb, Half Dome Sphere, Jet Fighter, Vortex Panel
- C. 7713-0** \$32,620.00  
Size: 18' x 16' x 8'4"  
Capacity: 22  
**Featured Components:**  
Turbo Tube, Driving Panel, Lookout Sphere, Hook Slide
- D. 7716-0** \$81,033.00  
Size: 24' x 16' x 14'3"  
Capacity: 68  
**Featured Components:**  
Spiral Slide, Safari Jeep, Turbo Tube, Ball Turn Panel
- E. 8043-3** \$50,747.00  
Size: 16' x 12' x 14'4"  
Capacity: 36  
**Featured Components:**  
Shoe Saver, Vertical Squeeze, Tic-Tac-Toe Panel, C-Force Panel
- F. 8243-0** Call for pricing  
Size: 40'4" x 37' 111/4" x 12' 1/4"  
Capacity: 110  
**Featured Components:**  
Turbo Tube, Tic-Tac-Toe Panel, Maze Pads, Punching Bags
- G. 8314-0** \$46,890.69  
Size: 26'3" x 20'3" x 8'4"  
Capacity: 42  
**Featured Components:**  
Turbo Copter, Crawl Tubes, Turbo Tube, 2-Way Cube
- H. 8334-0** Call for pricing  
Size: 24' x 20' x 12'4"  
Capacity: 46  
**Featured Components:**  
Punching Bags, Log Jam, Lookout Spheres, Maze Pads
- I. 8432-0** \$43,451.00  
Size: 12' x 10' x 8'4"  
Capacity: 20  
**Featured Components:**  
Gear Panel, Driving Panel, Deck Climb, Mirror Panel
- J. 8460-0** \$94,676.00  
Size: 24' x 16' x 18'4"  
Capacity: 60  
**Featured Components:**  
Shoe Saver, Hook Slides, Punching Bags, Web Crawl

**A. Slide System 103** \$12,021.00  
 • 18' flume; 6' deck height



A

**B. Slide System 107** \$23,847.00  
 • 24' flume; 6' deck height  
 • 25' flume; 10' deck height



B



A

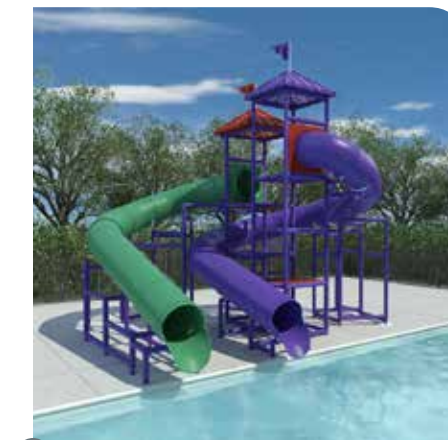

B

**A. Slide System 206** \$31,882.00  
 • 33' flume; 8' deck height  
 • 36' flume; 10' deck height

**B. Slide System 207** \$42,448.00  
 • 35' flume; 10' deck height  
 • 46' flume; 12' deck height

**C. Slide System 108** \$16,830.00  
 • 33' flume; 8' deck height



C

**D. Slide System 203** \$29,978.00  
 • 29' flume; 10' deck height



D



C

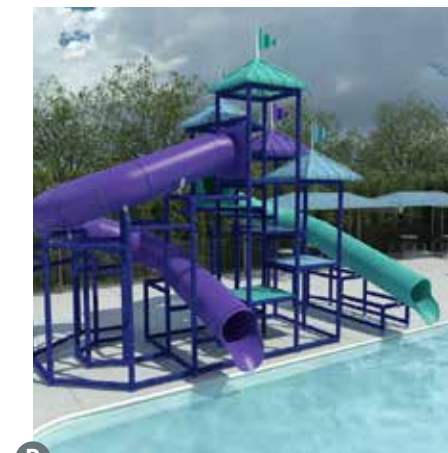

D

**C. Slide System 302** \$40,612.00  
 • 38' flume; 10' deck height  
 • 39' flume; 12' deck height

**D. Slide System 303** \$52,397.00  
 • 33' flume; 10' deck height  
 • 46' flume; 12' deck height

**E. Slide System 204** \$26,384.00  
 • 45' flume; 10' deck height



E

**F. Slide System 205** \$30,495.00  
 • 46' flume; 12' deck height



F



E

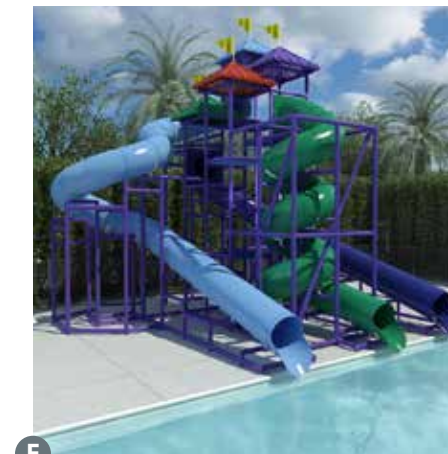

F

**E. Slide System 304** \$52,634.00  
 • 43' flume; 10' deck height  
 • 48' flume; 16' deck height

**F. Slide System 306** \$77,756.00  
 • 43' flume; 12' deck height  
 • 48' flume; 16' deck height  
 • 65' flume; 18' deck height





**9' x 9' Umbrella Hip Mini-Shelter**  
\$5,912.00



**28' Pittsburgh Double Tier**  
\$16,652.00



**28' Double Tier Octagonal**  
\$19,093.00



**16' x 24' Pittsburgh Hip\***  
\$13,196.00  
\*Weathervane not included

# Shelter Structures

**Picnic shelters and event pavilions that turn heads.**

Shelters aren't just stylish ways to relax and stay protected from the array of elements; they have the ability to generate revenue for your community. Unlock this potential with our many options by renting out these top notch structures for birthday, graduation, and every day celebrations. Our collection of pavilions and shelters are perfect for environments ranging from parks and schools, to zoos and amusement parks. Whether

you are in need of a garden gazebo, or customized event shelter, we offer the best in the industry. We are passionate about turning your one of a kind ideas into the spark of your community. Your visitors and community members will be thrilled with the comfort and design of our commercial outdoor gazebos, pergolas and shelters. We work with architects and landscapers on all project sizes. Each project is given specialized attention and materials that can withstand practically any harsh condition!



**Agility Features**



**Through the Tunnel**  
FPTTT001 \$1,928.00



**Jump Through**  
FPJT0001 \$460.00



**High Jump**  
FPHJ0001 \$237.00



**Limbone Anyone**  
FPLA0001 \$282.00



**Over and Under**  
FPOU0001 \$279.00



**Home Sweet Home**  
FPHSH001 \$1,876.00



**Camel Hump Climber**  
FPCH0001 \$2,310.00



**Leash Time**  
FPLT0001 \$204.00

# Dog Park Equipment

**Your dogs can count on us for finding fun!**

Dogs are a fundamental part of our communities and families; and they too deserve the best we have to offer for fun! Efficient Amenities offers a special line of playground equipment specified just for your canine friends. Turn your community park or vacant lot of land

into a world of tunnels, ramps, and jumps for your furry companions. Free of their leashes and limits, your dog can enjoy running free and staying healthy with other canines alike. Let your pets enjoy the fun and exercise Efficient Amenities provides!

**Amenities**



**DogiPot Pet Station**  
1003-L \$349



**Pet & Companion Fountain**  
5400-90 Call for price



**Custom Dog Park Benches**  
B6WBULPERF-CUST-DP \$405.30



A



B

**A. 28' x 30' x 8' Rectangle**  
RD283008SG \$4,839.45

**B. 20' x 20' x 8' Hexagon**  
HD202008SG \$4,251.45



C



D

**C. 50' x 100' Megaspan Shade**  
Call for pricing

**D. Modular Playground Shade**  
Call for pricing



E



F

**E. 16' x 16' Vista Hexagon**  
V50H \$5,873.00

**F. 7' x 6.5' Picnic Shade**  
STS765SM \$908.25



G



H

**G. 16' x 16' Hexagon Umbrella**  
HU1616081G \$2,406.60

**H. 10' x 10' Portable Retractable Umbrella**  
PRU1010 \$4,900.00

# Shade Structures



Enjoy durable and iconic shade designs that go the distance.

With the ever changing weather conditions and an increased awareness in the harm of UV rays, providing protection from the elements has become a top priority in recreational design. Our team of experts work hard to create a safe haven from weather conditions while maintaining a stylish outlook. We can provide protection within and around schools, hotels, pools, stadiums,

rooftops, docks and anything in between. You are guaranteed a professional design that is customized to your environment and specific needs, while maintaining a sleek style and look that will appeal to your community. The dedicated team assigned to your project partners excellent service and product in a quick time frame; all while maintaining the highest standard of professionalism.

**A. Walkway Canopy Shade**

SC1616 Call for pricing



**B. 20' x 18' x 9' Cantilever**

RC201809SN \$4,247.25



**C. 31' x 14' x 11' T-Cantilever**

TC311411SG \$3,983.75



**D. 12' x 12' x 8' Cantilever Umbrella**

CU121208IG \$2,434.95



**E. Hypar Sail Umbrella**

Call for pricing



**F. Wavecrest Sail**

Call for pricing



**G. Multi-Sail**

Call for pricing



**H. Unique Custom Sail**

Call for pricing

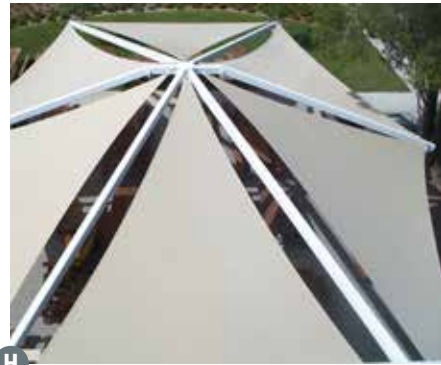

# Site Amenities

Over 1,000 economical, durable, comfortable designs to choose from.

Efficient Amenities offers more than 1,000 products in a multitude of different styles and color choices. Distinction and one of a kind projects are easily achieved with our many style and frame configurations; meaning a simple picnic area can portray your community in a distinctive landmark. Pairing with our team you are assured high quality indoor and outdoor amenities all at the best

prices available! We pride ourselves on providing the most durable and economically savvy conveniences to make your space stand out from the rest. Our years of experience in combination with our newest coating technology and high strength materials make us the top choice within the industry.



Wood



**6' 2" Treated Pine Table**  
11135-5 \$324.29



**6' Economy Treated Pine Bench**  
11642-1 \$250.00



**32 Gal. Wood Slat Receptacle**  
12428-1 \$215.71



**48" Pedestal Treated Pine Table**  
12894-2 \$621.43



**6' Contour Treated Pine Bench**  
11641-13 \$432.86



**6' ADA Treated Pine Table**  
12607-5 \$324.29

Recycled Plastic



**4' Heritage Bench**  
PB4CEDHER \$620.00



**6' Heritage Picnic Table**  
PB6CEDBFHERPIC \$1,500.00



**20' Gal. Receptacle**  
PB20JAMCED \$475.00



**6' Central Park Bench**  
PB6CEDCPE \$435.00



**Adirondack Chair**  
PBADSEAWHI \$325 – ask for accessories!



**32 Gal. Ridgeview Receptacle**  
PB32RIDCED \$640.00

Metal



**6' Portable Rectangle Expanded Table with 2 Seats**  
T6L \$625.80



**46" Portable Square Expanded Table with 4 Seats**  
T46UL \$708.75



**6' Canopy Table**  
320-V6 \$4,090.00



**32 Gal. Avenue Receptacle**  
TR32AVENUEEXP as Shown \$604.15



**32 Gal. Expanded Trash Receptacle**  
TR32L as Shown \$310.15



**6' Expanded Bench with Back**  
B6WBLSM \$360.15

Premium



**6' Richmond Bench with Back**  
61S-CDR6 \$1,062.00



**6' Wilmington Bench**  
P974-HS4 \$885.00



**32 Gal. Metro Receptacle**  
TR32METRO \$771.75



**6' Richmond Table with 2 Seats**  
64-CDR6 \$1,401.00



**36" Hamilton Table Top with 4 Seats**  
30S-S \$2,539.00



**32 Gal. Richmond Receptacle**  
60-CDR34FT \$854.00

**Concrete**



**Radius Polished Concrete Bench**  
TF5116 \$561.34



**Westlake Concrete Bench with Back**  
TF5065 \$905.34



**30 Gal. Waste Receptacle with Push Door Top**  
TF1015 \$306.67



**Park Table**  
TF3226 \$1,124.00



**Round 4 Seat**  
TF3125 \$1,194.67



**30 Gal. Waste Receptacle with Pitch-in Top**  
TF1010 \$265.34

**Universal Access**



**8' ADA Treated Pine Table**  
11138-29 \$277.14



**6' ADA Perforated Table with 2 Seats**  
T6PERFHDCP \$780.00



**ADA Square Table with 3 Seats**  
TF3123 \$1,141.34

**Recycle Stations**



**53 Gal. Station with Push Door Top**  
TF1030 \$429.34



**2-24 Gal. Recycling and Waste Station**  
TF1196 \$1,152.00



**2-32 Gal. Round Recycling Center**  
PB64CEDREC \$890.00

**Bike Racks**



**Dero Fixit Toolkit with Airkit 3**  
FIXIT \$1,265.00



**Bike Bike Rack**  
BIKE BIKE RACK \$467.00



**Arc Rack**  
ARC RACK \$236.00

**Bollards**



**Brooklyn Concrete**  
TF6004 \$225.34



**Round Concrete with Reveal Line**  
TF6010 \$220.00



**6 Sq. Dover, 3' Inground P/C**  
2023S \$350.00

**Fountains**



**Barrier Free Drinking Fountain with Pet Fountain Attachment**  
5400-90 Call for pricing



**Barrier Free Aggregate Drinking Fountain with Pet Fountain Attachment**  
APF-3500-94 Call for pricing



**Water Bottle Filler with Pet Attachment**  
7700-90 Call for pricing

**Grills**



**Standard Park Grill**  
100-BK \$152.86



**Medium Group Grill**  
11696 \$370.00



**Smoker Grill**  
14645-1-1 \$397.14

**A. Fan-Shaped Aluminum Backboard with Orange Target and Border**  
1750B \$450.00



A

**B. Basketball Goal**  
PK4560 \$1,300.00



B

**C. Varsity Jam Adjustable Basketball System**  
GP7G60 \$895.00



C

**D. Sideout Outdoor Volleyball System**  
ODVB \$600.00



D

**E. Soccer Goals – Set of 2 with Nets**  
60019202XX \$1,064.00



E

**F. Soccer Goal – 8' x 24' – Set of 2 with Nets**  
SGSQ824PT \$2,500.00



F



A

**A. 3 Row 9'L Low Rise**  
BL39LR \$590.00



B

**B. 4 Row 15'L Low Rise**  
BL415LR \$1,325.00

**C. 10 Row 15'L Non-Elevated**  
BL1015NE \$7,655.00

**D. T-Cantilever for 3 Row Low Rise with Glide Elbow**  
TC121009IG \$2,189.00

**E. Hanging Cantilever for 4 Row Low Rise with Glide Elbow**  
HC201210IG \$2,784.00

**F. Suspended Cantilever for 10 Row Non-Elevated with Glide Elbow**  
SC202015IG \$5,051.00



C

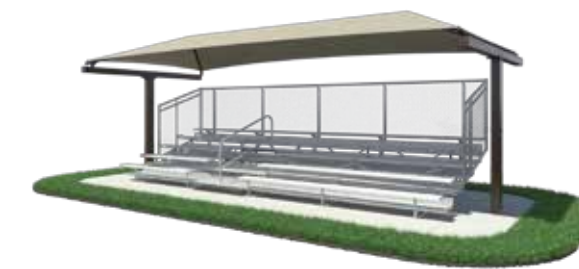

D

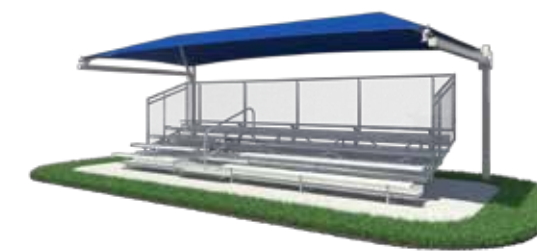

E

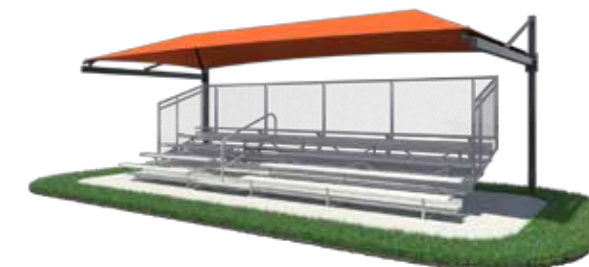

F

# Safety Surfacing

**Don't forget to finish your space with the perfect landing.**

We provide numerous combinations of safety surfaces for your indoor and outdoor spaces. These surfaces are the perfect addition to your parks or even pools; creating the safest and most durable materials for your specialized project. Your options range from artificial turf and poured rubber, to loose fill rubber and

hardwood mulch. These surfaces are also maintained by our knowledgeable team, allowing maximum use of your covering. We will be with you every step of the way, offering our recommendations and years of experience for years to come.



**Synthetic Grass**

ADA accessible, reduced maintenance costs, and meets ASTM, CPSC, and CSA standards. This synthetic yet life-like grass-alternative is a durable option for many recreation environments.

**IDEAL APPLICATIONS:**

Playgrounds, Indoor Playgrounds, Dog Parks, Splash Pads, Fitness Trails, Recreation Fields



**EPDM Rubber**

Base (impact) layer comprised of black, 100% post-consumer recycled rubber (SBR). Cap (wear) layer made of 1/2" coloured EPDM. An industry leader in amount of urethane binder in both layers.

**IDEAL APPLICATIONS:**

Playgrounds, Indoor Playgrounds, Splash Pads, Fitness Trails



**Bonded Rubber**

Colored 100% post-consumer recycled rubber (SBR). Time and money-saver. Drains quickly and designed to be resistant to daily thermal expansion/contraction.

**IDEAL APPLICATIONS:**

Playgrounds, Landscaping, Fitness Course, Walking Trails



**Aquatic**

High traction soft rubber polymer tile flooring. Highly shock absorbing, stain resistant and durable. Large array of colors, waterjet patterns, and textures, bring aquatic environments to life.

**IDEAL APPLICATIONS:**

Indoor and Outdoor Pools, Splash Pads, Residential, Hospitality, Fitness, Parks



**Playground Surfacing Patch Kits**

- Easy application
- All-in-one kit
- No mixing equipment required
- Cover up to 6 square feet
- Repairs punctures, holes, cracks, due to vandalism and excessive use.

**IDEAL APPLICATIONS:**

Playgrounds, Indoor Playgrounds, Splash Pads, Fitness and Walking Trails



**Grassmats**

Covering 5' x 3.3' and made from 30% recycled rubber, Grassmats offer the ultimate in multipurpose matting.

**IDEAL APPLICATIONS:**

Playgrounds, Dog Parks, Fitness and Walking Trails, Recreation Fields, Landscaping, Special Events, Multi-purpose flooring

**After Sale Service Information**



Understand that you'll have access to service, parts, warranty, and customer support through not just our office administrators, but also our manufacturing partners. We are conveniently located within one mile from several of our manufacturers for playground equipment, shade structures and umbrellas, shelter and pavilions, water slides and splash pads, indoor playground equipment, and site amenities.

Your equipment is warranted for both installation, as well as a manufacturer's warranty. You will need to have service, replacement hardware, or maintenance at some point during the lifetime of your product. You'll want a dealer that's geographically tied to your manufacturer to deliver the replacement parts. Most of your hardware is vandal resistant, and not easy to be found locally.

**Pricing Policy**

All prices listed in this catalog are FOB factory and do not include freight, shipping and handling, or taxes. All prices are current as of spring 2016 in USD. All prices are subject to change without notice.

**Contact Us**

-  View product info, request a quote  
[e-menities.com](http://e-menities.com)
-  Send us a message  
[sales@e-menities.com](mailto:sales@e-menities.com)
-  Call us  
**1.855.884.8387 | 1.678.390.1590**





**EFFICIENT  
AMENITIES**



View Products, Request Quote  
[e-menties.com](http://e-menties.com)



Send Us a Message  
[sales@e-menties.com](mailto:sales@e-menties.com)



Call Us  
**855.884.8387**  
**678.390.1590**